

Before you begin, please follow assembly instructions carefully, then follow them step by step.

Read instruction carefully . See Furniture Parts list and Hardware List for guidance . Be sure you have all parts before you start assembling . Place and assemble furniture on a clean flat soft surface , such as carpet or rug to prevent being scratched .

P. NO : 1/2	PART LIST		QTY
	1	SIDE PANEL(L)	1 PC
	2	SIDE PANEL(R)	1 PC
	3	TOP PANEL	1 PC
	4	BOTTOM PANEL	1 PC
	5	BACK PANEL	2 PCS

P. NO : 2/2	HARDWARE		
	E	3.5 X 18MM SCREW	32 PCS
	G	4 X 50MM SCREW	8 PCS
	H	NAIL	30(±5) PCS
	I	PLASTIC CAP	4 PCS
	N	PLASTIC RAIL	16 PCS
	O	PLASTIC LEG	4 PCS
	BG	4 X 20MM SCREW	12 PCS
	PLASTIC BASKETS		

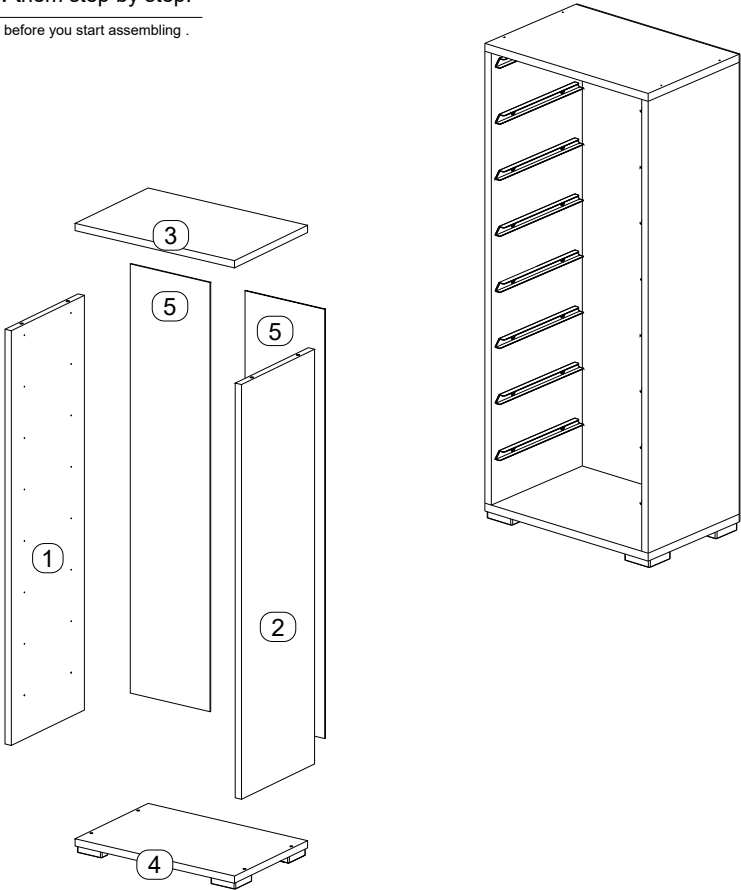

Reminder:
Please ensure that all surfaces and edges with colours/laminations are facing forward/outward.

STEP 1
Fix hardware N onto side panel (1,2) by using hardware E.

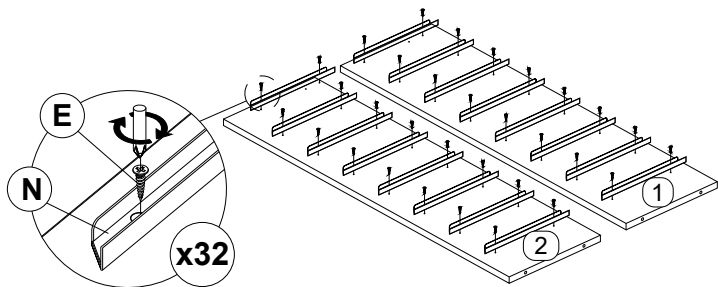

STEP 2
Connect panel(3,4) to side panel(1,2) by using hardware G.
(Repeat 4 times.)

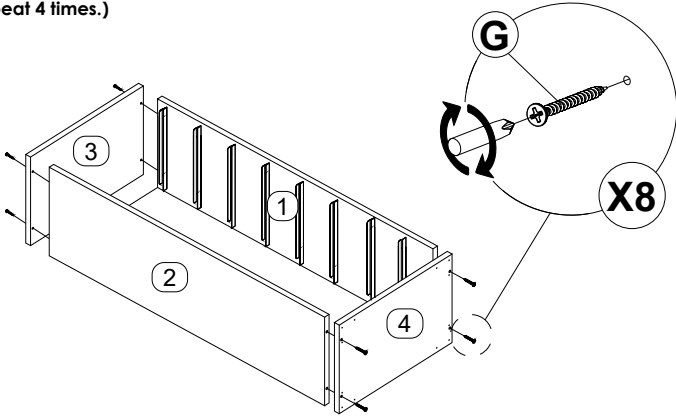

STEP 3
Fix hardware O onto panel(4) by using hardware BG.

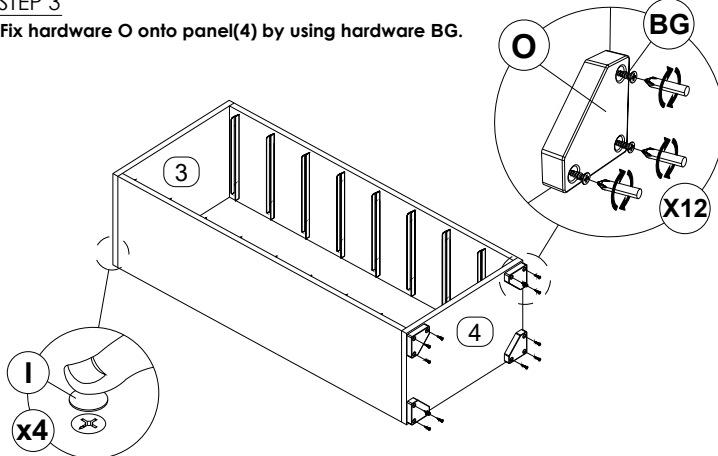

STEP 4
Assemble panel(5) to entire body with hardware H.

